

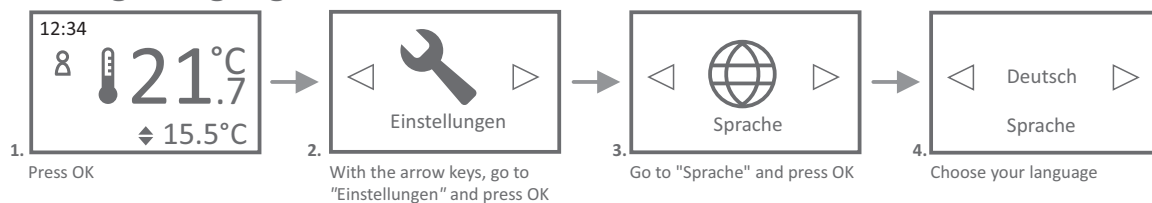

AeroFlow® electric heater user manual

General Information	Page 2
Guarantee conditions	Page 2
Manual on assembly of the wall bracket	Page 3
Manual for FlexiSmart controller	Page 4-6

Change language



General Information

1. Safety instructions

Please read the user manual of your new AeroFlow® electronic radiator and the information listed here carefully. Store these instructions in a safe place and pass them on to the following user/owner if necessary. The electronic heating you have just purchased is only suitable for heating inside enclosed rooms. Damaged devices (e.g. damaged connecting cables) must not be operated.

Our radiators are tested according to the applicable IP protection class when properly installed (International Protection Code – in this case: Protected against spray water). In the fixed electrical installation, a separating device with at least a 3mm contact opening shall be provided on each pole (for example, a safety device, residual current circuit breaker). Substances which are prone to ignition or thermal decomposition (e.g., adhesives of floor coverings) may only be used if it is **certain** the heater has been cooled to room temperature. The heater must not be placed directly below a wall socket.

The radiator is not intended to be used by persons (including children) with limited perceptual abilities or by people with lack of experience and / or lack of knowledge of using it. Unless they are supervised by a person responsible for their safety or have received instructions from this person on how to use the radiator. Children should be supervised to ensure that they do not play with the radiator.

2. Electrical connection

Your AeroFlow® electric radiator system is suitable for fixed connection to wall sockets or operation from power sockets. An electrician must be consulted when installing it via a wall socket. If the mains connection cable of the radiator is damaged, it needs to be replaced by us or a suitably qualified electrician in order to prevent danger and additional damage.

The radiator may only be operated with a thermostat directly on the radiator or with an external control. The heating control must always be performed using a suitable room thermostat.

3. Installation

Our devices are mounted horizontally on the wall. Attachment to the ceiling is not permitted. The radiator should normally be installed under a window or on an external wall. Please ensure that the radiator can radiate into the room as freely as possible. You can find our detailed installation information on Page 3.

4. Heating

The radiator is controlled via the externally or internally installed room thermostat. A higher setting means a longer operating time. Please refer to the operating instructions of the room thermostat on the following pages. It is possible that a slight odour can develop during initial commissioning, since some materials still have to emit fumes. This does not pose any threat, and it will stop after a period of time. Please ventilate the rooms well if necessary. In rare cases, noise can occur in the form of cracking, which is caused by heat-induced material movements, which are harmless.

5. Overheating protection

For your safety, the heater is equipped with a temperature switch integrated in the heating system. If the radiator is not heated in the permitted manner (e.g. by covering or blocking) the radiator switches off automatically. The covering of the heater (e.g. through towels) during operation is not permissible, it is a fire hazard! Any resulting defects on a temperature switch and the resulting costs for the repair shall be borne exclusively by the party causing the damage. We can offer you a towel rack suitable for our radiators in our online shop.

6. Malfunctions

If the radiator does not emit any heat, please check that the thermostat is pre-set to the desired temperature. In addition, it is essential to check that the local power distribution is switched on or that the fuse is in working order. If you encounter such malfunctions, please contact your installer. In the event of a complaint being addressed to us, the serial number of the device is required for order processing. You will find this information on the rating plate.

7. Cleaning of device

Switch the radiator off before each cleaning sequence and allow it completely cool down. Only wipe the radiator off with a soft, damp cloth and do not use any chemical detergents or abrasive. A correspondingly designed cleaning brush can be used for the cleaning of the slats (not included). We offer you an appropriate product in our online shop for purchase in the accessories section.

8. Directions for disposal

Disposal of old equipment in Germany

The devices marked with the symbol below must not be disposed of with household waste. As a manufacturer, we are responsible for the environmentally sound treatment and recycling of WEEE as part of our production responsibility. Please contact your local authority for further information on collection and disposal. If necessary, name the following number WEEE-Reg.-No. DE 46197075 .



Disposal outside of Germany

Dispose of these appliances in an expert and proper manner in accordance with local legislation and regulations.

Guarantee conditions

For this product, we provide a 30-year warranty on the area of heat generation and usability of the basic unit as well as a 2-year warranty on the control technology, the spare parts and the accessories.

In other respects that statutory warranty shall apply. Our warranty conditions regulate the additional warranty claims, which are in addition to the statutory warranty claims of the customer.

The warranty conditions apply only to devices which are purchased by the end user as new devices. A guarantee obligation does not come about insofar as the final customer purchases a used device or for its part a new device from another end customer.

The warranty is provided if a manufacturing and/or material fault occurs during the warranty period on our radiators and the accessories.

Within the warranty period that commences upon the delivery date, we will remedy free of charge any malfunctions that are demonstrably due to a material defect or defective performance.

Our guarantee includes the free exchange of defective parts as well as the provision of free spare parts during the warranty period.

We are only liable if the function of the radiator is impaired and the defect is not caused by negligent, intentional or improper handling, use of force, transport, misuse, connection to incorrect mains voltages, failure to observe the appropriate operating instructions or installation instructions, improper cleaning or corrosion damage due to caustic water, by chemical and / or electrochemical effects or by normal wear and tear.

The warranty will become void if the unit has been subjected to interventions or attempted repairs by persons who have not been authorised to do so by us. Please note that dismantling of the heater by the customer or third parties is fundamentally not permissible. If there is a violation this warranty entitlement shall cease to apply.

The possible replacement of the radiator side part (e.g. when changing the control technology) and / or the possible shortening of the connecting cable (e.g. removal of the earthed plug for the purpose of producing a fixed connection) does not lead to a loss of warranty, insofar as no intervention in or manipulation of electronic components takes place, beyond the necessary extent of the modification to be performed, and the correspondingly permissible work is performed by a qualified expert.

The warranty covers the careful inspection of the radiator or the accessories whereby it must be initially determined whether a warranty claim applies. In the event of a claim under the warranty we solely decide in which manner the fault shall be rectified. We are at liberty to replace a radiator or accessory or to perform a repair. During the warranty period, we assume all material, assembly and transport costs within the scope of this warranty.

In addition to the above-mentioned warranty service, the end customer cannot assert any claims for indirect damage or consequential damage caused by the device, in particular for compensation for damages incurred outside the device. Statutory claims of the customer against us shall remain unaffected by this clause. Warranty claims must be reported to us before expiry of the warranty period, within one week of the defect being detected.

🇬🇧 Fixing the wall brackets

Only the wall bracket supplied may be used for wall mounting! The latest regulations according to VDE 0100 part 701 must be complied with for the installation and operation in damp rooms.

The device may not be mounted directly under a wall socket. In order to avoid excessive heat radiation upon the wall socket, a certain safety distance must also be taken into account between the radiator and the wall socket. This distance is largely determined by the material quality and heat resistance of the locally installed socket and therefore can not be assessed by us. We assume no liability for improper handling and possible damages resulting from this. In case of doubt, consult a specialist before installation. Suitable screws and dowels must be used depending on the type and condition of the wall material. When positioning the wall bracket and the heater, please always observe the stipulated minimum distances (see the following figures).

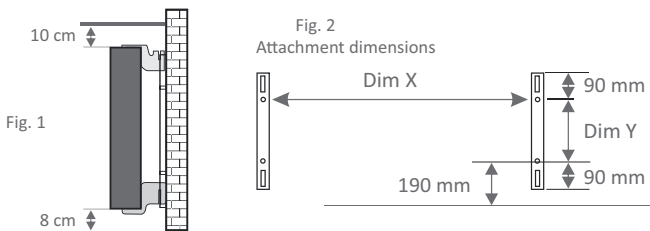

All radiators have four temperature-resistant holders, which guarantee optimum fixing of the heater. Please note the correct hanging position of the upper (marking 1) and lower (marking 2) holders on the heater (see following figures).

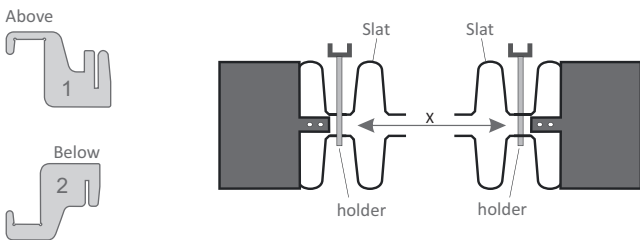

With the type-specific dimension table, you can obtain the correct positioning for the U-rails and the holders for the correct mounting and fixing of the radiator.

Radiator type	Dim X in mm	Dim Y in mm	Radiator type	Dim X in mm	Dim Y in mm
MINI 650	232	405	SLIM TALL 1600	232	1040
COMPACT 1300	466	405	SLIM 1200	766	120
MIDI 1950	766	405	SLIM 1600	1066	120
MAXI 2450	1066	405	SLIM 2000	1366	120

For the assembly please perform the following steps:

1. The two U-rails must be fixed to the wall whilst observing the minimum distances and depending on the type-specific X / Y-dimension.
2. The two holders marked with the number 2 are to be inserted into the U-rails at the bottom.
3. Following this the radiator is hooked into the lower holders and tilted forward at an angle. Hold the radiator while doing so!
4. The two holders marked with the number 1 are to be inserted into the U-rails at the top and temporarily pulled up.
5. Finally, place the radiator in a vertical position and press the upper holders down until the heater is completely fixed in place.

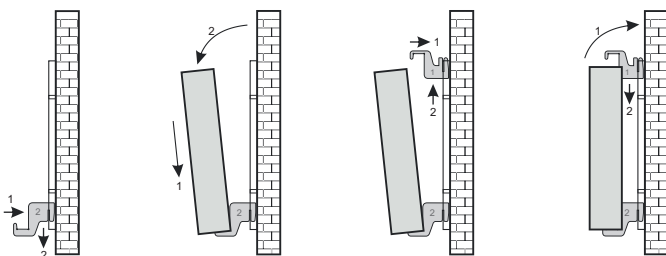

Note - alignment of the temperature sensor

The temperature sensor is attached to the bottom of the radiator in a clip. If, due to the placement of the device in a niche or corner, the room temperature and the measured temperature is influenced, the sensor can be removed from the clip. The distance to the radiator can be increased by turning the connection cable of the sensor. **The best way to correct the temperature is in the menu settings, "temperature correction"  .**

Smart Start (adaptive start control)

With this function, the desired room temperature is met at the start time of the program. This means that the heater is already heating before the set start time. This is not a malfunction! Smart Start can only be used in program mode. You can deactivate Smart Start in the menu item "Programs". When Smart Start is deactivated, the electric radiator starts heating when the preset start time is reached.

Learning phase: In order to reach the target temperature exactly at the start time of each programmed time frame, your FlexiSmart performs a learning phase in the first seven days. During this time, heating is always started 15 minutes before the set start time (in every single time window).

As a result, the FlexiSmart controller learns how fast or slow heating takes place in the room and adjusts the "smart start time" of heating. After the learning phase, the FlexiSmart controller decides when to start heating up. Your rooms will be heated up as effectively as possible.

Switch daylight saving time to standard time

The FlexiSmart controller does *not* have an automatic changeover between daylight saving time to standard time. You must change the time manually in the "Set the time" menu.

Exception: If the FlexiSmart controller is connected to an internet module, an automatic changeover takes place between daylight saving time to standard time.

German battery legislation

Since batteries and rechargeable batteries may be included in our consignments, we are obliged by the German battery legislation (BattG) to point out the following: Batteries and rechargeable batteries must not be disposed of with household waste, but you are legally obliged to return used batteries and rechargeable batteries. Used batteries may contain harmful substances which, if not properly stored or disposed of, could damage the environment or your health. But batteries also contain important raw materials such as iron, zinc, manganese or nickel and can be recycled. You can either return the batteries to us after use or return them free of charge in the immediate vicinity (eg in stores or in municipal collection points). The discharge in points of sale is limited to end user customary amounts and such batteries that are sold or have been sold from the distributor as new batteries in his assortment.

Status display

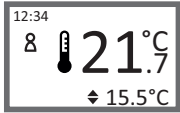

The first menu you will see after switching your AeroFlow® heater will show the current time on the top left (for setting see page 6). The large temperature next to the thermometer icon shows the current room temperature. The small temperature in the lower right corner shows the target temperature.

- Depending on the program setting, the following icons are visible:
- = Manual mode (program mode Off). The target temperature will be controlled via the arrow buttons.
 - = The AeroFlow® heater is in program mode (see page 4/5).
 - = The radiator is about to warm the room. As soon as the set room temperature is reached, this symbol disappears.
 - = Open window detected, the AeroFlow® heater is temporarily switched off.
 - = Holiday Mode: The digit below the icon indicates the number of remaining holidays (see page 5).
 - = Keylock/Childlock ON (to enable/disable press both arrow buttons simultaneously for min. 5 sec.).

NOTES:

If the clock symbol (program mode) is not displayed, lower or raise the target temperature by using the arrow buttons. The AeroFlow® heater will always hold this temperature.

In case the program mode is enabled (the clock symbol is displayed), the target temperature can also be lowered and raised with the arrow buttons. The manually set target temperature overrides the program mode until the next preset start or end time of a time frame. The AeroFlow® heater returns to programming mode after then.

To turn the heater off, keep the OK button pressed for at least 5 seconds.
 "Standby" will be displayed. Power consumption in standby mode below 0.1 watts.

Temperature-Overview

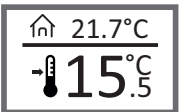

The display view changes after 5 seconds without pressing a button. The current temperature is displayed on top and the target temperature at bottom.

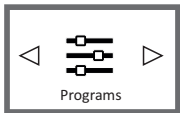

In this menu you can change or view your heating times.
You don't see this menu item?
 Enable the programming mode in the configuration menu by switching "Programs" to "ON".



Select this menu if you want to view the heating plan. You can not make changes in this menu item.

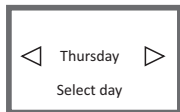

Select the day of the week for which you want to see the heating plan.

Start	End	Temp
00:00	08:00	11,0°C
08:00	16:00	19,0°C
16:00	00:00	11,0°C
--:--	--:--	-- °C
--:--	--:--	-- °C
--:--	--:--	-- °C

See the heating plan on the chosen day. Press OK to exit the menu item display.

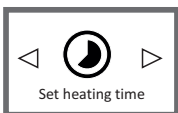

Set a heating plan according to your preferences.

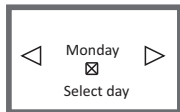

Choose the day of the week. You can select multiple, non-consecutive days. Navigate with the arrow buttons to the desired days and select them with OK. **Navigate with the arrow buttons to "Set frames" and press OK.**

Select Time Frame	Start	End	Temp
00:00	08:00	11,0°C	
08:00	16:00	19,0°C	
16:00	00:00	11,0°C	
--:--	--:--	-- °C	
--:--	--:--	-- °C	
--:--	--:--	-- °C	

Use the arrow buttons to select changes to a time frame. Confirm with OK.

Select Time Frame	Start time	Temp
00:00	08:00	11,0°C
08:00	16:00	19,0°C
16:00	00:00	11,0°C
--:--	--:--	-- °C
--:--	--:--	-- °C
--:--	--:--	-- °C

Use the arrow buttons to select the start time for the respective time frame. Confirm with OK.

Select Time Frame	End time	Temp
00:00	08:00	11,0°C
08:00	16:00	19,0°C
16:00	00:00	11,0°C
--:--	--:--	-- °C
--:--	--:--	-- °C
--:--	--:--	-- °C

Use the arrow buttons to select the end time for the respective time frame. Confirm with OK.

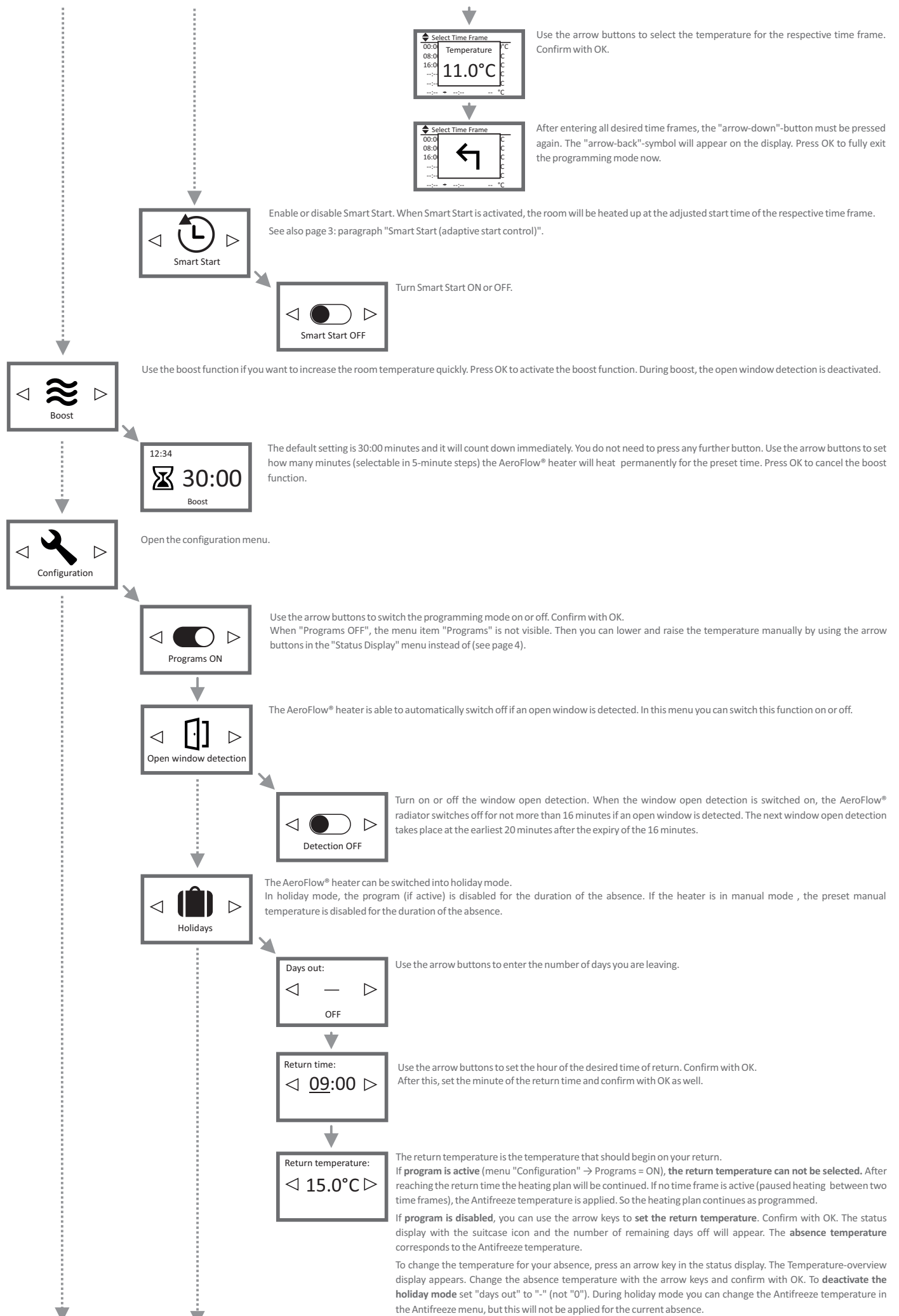

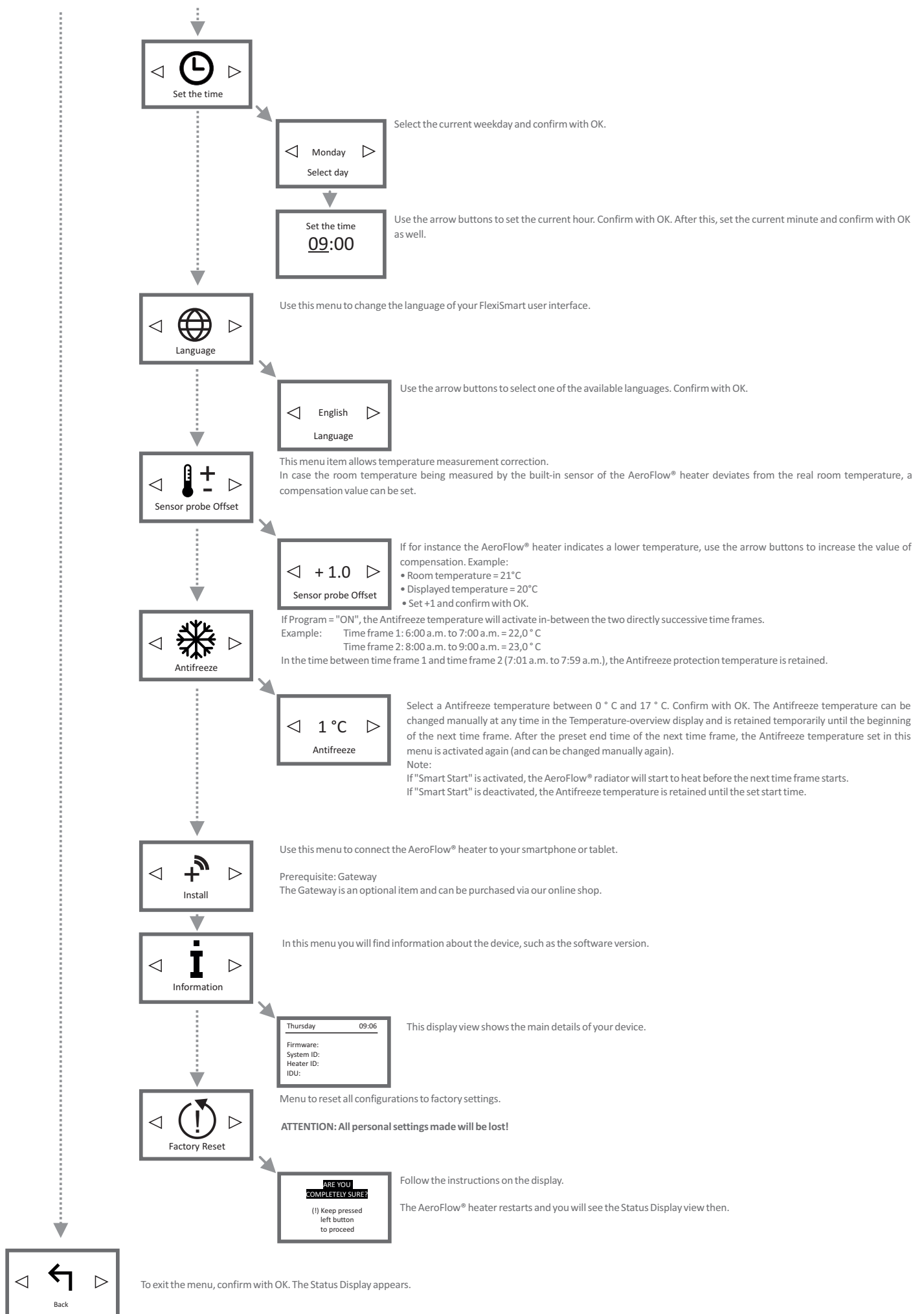

Table 2 of the COMMISSION REGULATION (EU) 2015/1188 as of 28 April 2015

Information requirements for electric local space heaters

Model identifier(s):		MINI 650 FlexiSmart	COMPACT 1300 FlexiSmart	MIDI 1950 FlexiSmart	MAXI 2450 FlexiSmart	SLIM TALL 1600 FlexiSmart	SLIM 1200 FlexiSmart	SLIM 1600 FlexiSmart	SLIM 2000 FlexiSmart	Model identifier(s):	MINI 650 Flexi-Smart	COMPACT 1300 FlexiSmart	MIDI 1950 Flexi-Smart	MAXI 2450 FlexiSmart	SLIM TALL 1600 Flexi-Smart	SLIM 1200 Flexi-Smart	SLIM 1600 Flexi-Smart	SLIM 2000 Flexi-Smart	
Item	Sym-bol	Unit	Value	Value	Value	Value	Value	Value	Value	Item	Unit	Unit	Unit	Unit	Unit	Unit	Unit	Unit	
Heat output										Type of heat input, for electric storage local space heaters only (select one)									
Nominal heat output	P _{nom}	kW	0,65	1,30	1,95	2,45	1,60	1,20	1,60	2,00	manual heat charge control, with integrated thermostat	N/A	N/A	N/A	N/A	N/A	N/A	N/A	N/A
Minimum heat output (indicative)	P _{min}	kW	0,65	1,30	1,95	2,45	1,60	1,20	1,60	2,00	manual heat charge control with room and/or outdoor temperature feedback	N/A	N/A	N/A	N/A	N/A	N/A	N/A	N/A
Maximum continuous heat output	P _{max,c}	kW	0,59	1,17	1,76	2,21	1,20	0,90	1,20	1,50	electronic heat charge control with room and/or outdoor temperature feedback	N/A	N/A	N/A	N/A	N/A	N/A	N/A	N/A
Auxiliary electricity consumption											fan assisted heat output	N/A	N/A	N/A	N/A	N/A	N/A	N/A	N/A
At nominal heat output	e _{l,max}	kW	0,0005	0,0005	0,0005	0,0005	0,0005	0,0005	0,0005	0,0005	Type of heat output/room temperature control (select one)								
At minimum heat output	e _{l,min}	kW	0,0005	0,0005	0,0005	0,0005	0,0005	0,0005	0,0005	0,0005	single stage heat output and no room temperature control	no	no	no	no	no	no	no	no
In standby mode	e _{l,SB}	kW	0,0001	0,0001	0,0001	0,0001	0,0001	0,0001	0,0001	0,0001	Two or more manual stages, no room temperature control	no	no	no	no	no	no	no	no
											with mechanic thermostat room temperature control	no	no	no	no	no	no	no	no
											with electronic room temperature control	no	no	no	no	no	no	no	no
											electronic room temperature control plus day timer	no	no	no	no	no	no	no	no
											electronic room temperature control plus week timer	yes	yes	yes	yes	yes	yes	yes	yes
											Other control options (multiple selections possible)								
											room temperature control, with presence detection	no	no	no	no	no	no	no	no
											room temperature control, with open window detection	yes	yes	yes	yes	yes	yes	yes	yes
											with distance control option	yes	yes	yes	yes	yes	yes	yes	yes
											with adaptive start control	yes	yes	yes	yes	yes	yes	yes	yes
											with working time limitation	no	no	no	no	no	no	no	no
											with black bulb sensor	no	no	no	no	no	no	no	no
Contact details	Thermotec AG Arnsdorf 26 02894 Vierkirchen Germany																		

warranty certificate

The AeroFlow® product family of Thermotec AG is available for a healthy indoor climate and cost-conscious heating. Our years of development work and a modern production process are the prerequisite for the longevity and high stability of value of your AeroFlow® product.



30-year warranty on heat generation and operability of the basic unit.

With the purchase of this device, you have decided for an innovative quality product of the absolute top class.

We thank you for your trust.

Sebastian Heidrich

Founder and chairman of Thermotec AG



Thermotec AG | Arnsdorf 26 | 02894 Vierkirchen | Germany
Phone: +49(0)3 58 27 78 93 30 | info@thermotec-ag.de

www.thermotec.ag/en

Thermotec AG
Arnsdorf 26
02894 Vierkirchen
Germany

Phone: +49(0)3 58 27 78 93 30
Fax: +49(0)3 58 27 78 93 444
email: info@thermotec-ag.de

www.thermotec.ag/en